



Report of: Service Director, Public Protection

Meeting of	Date	Agenda Item	Ward(s)
Licensing Sub-Committee	4 th November 2014		Mildmay

Delete as appropriate		Non-exempt
-----------------------	--	------------

Subject: PREMISES LICENCE NEW APPLICATION
Cengiz Place, 47 Green Lanes, London N16 9BU

1. Synopsis

- 1.1 This is an application for a new premise licence under the Licensing Act 2003.
- 1.2 The application is for a licence to allow:
 - The sale of alcohol for consumption on the premises: 17:00 to 23:00 on Monday to Sunday.

2. Relevant Representations

Licensing Authority	No
Metropolitan Police	Yes
Noise	No
Health and Safety	No
Trading Standards	No
Public Health	No

Safeguarding Children	No
London Fire Brigade	No
Local residents	Yes: 1
Other bodies (local business)	Yes: 1

3. Background

3.1 Papers are attached as follows:-

- Appendix 1: application form and supporting evidence
- Appendix 2: representations;
- Appendix 3: suggested conditions and map of premises location.

3.2 The Police, 1 local resident and 1 local business have submitted representations. The Noise Service did submit a representation with conditions, however these have been agreed by the applicant. The applicant sent a supporting letter to licensing and requested that I forward to the 2 reps, this was done.

3.3 Prior to this application the licensing team along with Police officers visited the premises in a joint working operation. The visit took place on 27th February 2013 and was aimed at premises suspected of making illegal gaming machines available for use to be played on their premises. Licensing officers spoke to the manager of the premises and explained that all of the gaming machines that were found were illegally sited, which is an offence under the Gambling Act 2005. The manager was warned that the machines would need to be removed immediately. A follow up visit took place in April 2013 and all the machines had been removed.

4. Planning Implications

4.1 Change of use to a private social club was granted in 1992. The use shall not operate except between the hours of 09:30 and 23:30 on any day.

5 Recommendations

5.1 To determine the application for a new premises licence under Section 17 of the Licensing Act 2003.

5.2 If the Committee grants the application it should be subject to:

- i. conditions prepared by the Licensing Officer which are consistent with the Operating Schedule (see appendix 3)
- ii. any conditions deemed appropriate by the Committee to promote the four licensing objectives.(see appendix 3)
- iii. any conditions deemed necessary by the Committee to promote the four licensing objectives.

Conclusion and reasons for recommendations

- 6.1 The Council is required to consider this application in the light of all relevant information, and if approval is given, it may attach such conditions as appropriate to promote the licensing objectives.

Background papers:

The Council's Statement of Licensing Policy

Licensing Act 2003

Secretary of States Guidance

Final Report Clearance**Signed by**
Service Director – Public Protection

Date

24-10-14

Received by

Head of Scrutiny and Democratic Services

Date

Report author: Licensing Service

Tel: 020 75027 3031

E-mail: licensing@islington.gov.uk

WJK/201456881

[Insert name and address of relevant licensing authority and its reference number (optional)]

**Application for a premises licence to be granted
under the Licensing Act 2003**

PLEASE READ THE FOLLOWING INSTRUCTIONS FIRST

Before completing this form please read the guidance notes at the end of the form
If you are completing this form by hand please write legibly in block capitals. In all cases ensure that your answers are inside the boxes and written in black ink. Use additional sheets if necessary.
You may wish to keep a copy of the completed form for your records.

I/We BERIVAN ULISOY apply for a premises licence under section 17 of
(Insert name(s) of applicant)
the Licensing Act 2003 for the premises described in Part 1 below (the premises)
and I/we are making this application to you as the relevant licensing authority in
accordance with section 12 of the Licensing Act 2003

Part 1 – Premises details

Postal address of premises or, if none, Ordnance Survey map reference or description <u>CENGL2 PLACE</u> <u>47 GREEN LANES</u> <u>NEWINGTON GREEN N</u>	
Post town	Post code <u>N16 9BU</u>

Telephone number at premises (if any)

N/A

Non-domestic rateable value of premises

£5000

Part 2 – Applicant details

Please state whether you are applying for a premises licence as

Please tick ☒ yes

- a) an individual or individuals* ☒ please complete section (A)
- b) a person other than an individual*
 i. as a limited company ☐ please complete section (B)
 ii. as a partnership ☐ please complete section (B)
 iii. as an unincorporated association or ☐ please complete section (B)
 iv. other (for example a statutory corporation) ☐ please complete section (B)
- c) a recognised club ☐ please complete section (B)

ISLEINGTON COUNCIL LICENSING	
19/8/14 Fee Paid	190
CASH	
47503	
ABN	

<input type="checkbox"/> please complete section (B)
COMMERCIAL LICENSING
<input type="checkbox"/> please complete section (B)
19 AUG 2014
PUBLIC PROTECTION DIVISION
222 UPPER ST, LONDON N1 1XR

- e) the proprietor of an educational establishment ☐ please complete section (B)
- f) a health service body ☐ please complete section (B)
- g) a person who is registered under Part 2 of the Care Standards Act 2000 (c14) in respect of an independent hospital ☐ please complete section (B)
- h) the chief officer of police of a police force in England and Wales ☐ please complete section (B)

*If you are applying as a person described in (a) or (b) please confirm:

- Please tick ✓ yes
- I am carrying on or proposing to carry on a business which involves the use of the premises for licensable activities; or ☐
 - I am making the application pursuant to a
 - statutory function or ☐
 - a function discharged by virtue of Her Majesty's prerogative ☐

(A) INDIVIDUAL APPLICANTS (fill in as applicable)

Mr ☐ Mrs ☐ Miss ☒ Ms ☐ Other title (for example, Rev) ☐

Surname

ULUSOY

First names

BERIVAN

I am 18 years old or over

Please tick ✓ yes



Current postal address if different from premises address

12B KENSINGTON HOUSE
ORANWOOD STREET

Post Town

LONDON

Postcode

EC1V 9PA

Daytime contact telephone number

07999202545

E-mail address (optional)

B.ULUSOY@LIVE.CO.UK

SECOND INDIVIDUAL APPLICANT (if applicable)

Mr ☐

Mrs ☐

Miss ☐

Ms ☐

Other title ☐
(for example, Rev)

Surname

First names

Please tick

✓ yes

☐

I am 18 years old or over

Current postal
address
if different from
premises address

Post Town

Postcode

Daytime contact telephone number

E-mail address
(optional)

(B) OTHER APPLICANTS.

Please provide name and registered address of applicant in full. Where appropriate please give any registered number. In the case of a partnership or other joint venture (other than a body corporate), please give the name and address of each party concerned

Name
Address
Registered number (where applicable)
Description of applicant (for example partnership, company, unincorporated association etc)
Telephone number (if any)
E-mail address (optional)

Part 3 Operating Schedule

When do you want the premises licence to start?

Day	Month	Year
01	09	2014

If you wish the licence to be valid only for a limited period, when do you want it to end?

Day	Month	Year

If 5,000 or more people are expected to attend the premises at any one time, please state the number expected to attend.

N/A

Please give a general description of the premises (please read guidance note 1)

47 GREEN LANES IS A SOCIAL CLUB WHERE MAINLY OVER 40S, USUALLY MEN WILL ATTEND TO SOCIALISE, SPEND TIME, PLAY CARD AND BOARD GAMES. IT IS A PLACE WHERE RETIRED PEOPLE WOULD COME TO RELAX AND COMMUNICATE WITH OTHERS.

What licensable activities do you intend to carry on from the premises?
(Please see sections 1 and 14 of the Licensing Act 2003 and Schedule 1 and 2 to the Licensing Act 2003)

Please tick ✓ yes

Provision of regulated entertainment

- a) plays (if ticking yes, fill in box A) ☐
- b) films (if ticking yes, fill in box B) ☐
- c) indoor sporting events (if ticking yes, fill in box C) ☐
- d) boxing or wrestling entertainment (if ticking yes, fill in box D) ☐
- e) live music (if ticking yes, fill in box E) ☐
- f) recorded music (if ticking yes, fill in box F) ☐
- g) performances of dance (if ticking yes, fill in box G) ☐
- h) anything of a similar description to that falling within (e), (f) or (g)
(if ticking yes, fill in box H) ☐

Provision of entertainment facilities for:

- i) making music (if ticking yes, fill in box I) ☐
- j) dancing (if ticking yes, fill in box J) ☐
- k) entertainment of a similar description to that falling within (i) or (j)
(if ticking yes, fill in box K) ☐

Provision of late night refreshment (if ticking yes, fill in box L)

☐

Supply of alcohol (if ticking yes, fill in box M)

☒

In all cases complete boxes N, O and P

A

Plays Standard days and timings (please read guidance note 6)			Will the performance of a play take place indoors or outdoors or both – please tick [Y] (please read guidance note 2)	Indoors <input type="checkbox"/>	<input type="checkbox"/>
				Outdoors <input type="checkbox"/>	<input type="checkbox"/>
				Both <input type="checkbox"/>	<input type="checkbox"/>
Day	Start	Finish	Please give further details here (please read guidance note 3)		
Mon					
Tue					
Wed			State any seasonal variations for performing plays (please read guidance note 4)		
Thur					
Fri			Non standard timings. Where you intend to use the premises for the performance of plays at different times to those listed in the column on the left, please list (please read guidance note 5)		
Sat					
Sun					

B

Films Standard days and timings (please read guidance note 6)			Will the exhibition of films take place indoors or outdoors or both – please tick [Y] (please read guidance note 2)	Indoors <input type="checkbox"/>	<input type="checkbox"/>
				Outdoors <input type="checkbox"/>	<input type="checkbox"/>
				Both <input type="checkbox"/>	<input type="checkbox"/>
Day	Start	Finish	Please give further details here (please read guidance note 3)		
Mon					
Tue					
Wed			State any seasonal variations for the exhibition of films (please read guidance note 4)		
Thur					
Fri			Non standard timings. Where you intend to use the premises for the exhibition of films at different times to those listed in the column on the left, please list (please read guidance note 5)		
Sat					
Sun					

Mon			Please give further details here (please read guidance note 3)
Tue			
Wed			State any seasonal variations for providing dancing facilities (please read guidance note 4)
Thur			
Fri			Non standard timings. Where you intend to use the premises for the provision of facilities for dancing entertainment at different times to those listed in the column on the left, please list (please read guidance note 5)
Sat			
Sun			

K

Provision of facilities for entertainment of a similar description to that falling within I or J Standard days and timings (please read guidance note 6)			Please give a description of the type of entertainment facility you will be providing	
Day	Start	Finish	Will the entertainment facility be indoors or outdoors or both – please tick [Y] (please read guidance note 2)	Indoor
				Outdoor
Mon				Both
Tue			Please give further details here (please read guidance note 3)	
Wed				
Thur			State any seasonal variations for the provision of facilities for entertainment of a similar description to that falling within j or k (please read guidance note 4)	
Fri				
Sat			Non standard timings. Where you intend to use the premises for the provision of facilities for entertainment of a similar description to that falling within I or J at different times to those listed in the column on the left, please list (please read guidance note 5)	
Sun				

L

Late night refreshment Standard days and timings (please read guidance note 6)			Will the provision of late night refreshment take place indoors or outdoors or both – please tick [Y] (please read guidance note 2)	Indoors	
				Outdoors	
Day	Start	Finish	Both		
Mon			Please give further details here (please read guidance note 3)		
Tue					
Wed			State any seasonal variations for the provision of late night refreshment (please read guidance note 4)		
Thur					
Fri			Non standard timings. Where you intend to use the premises for the provision of late night refreshment at different times, to those listed in the column on the left, please list (please read guidance note 5)		
Sat					
Sun					

M

Supply of alcohol Standard days and timings (please read guidance note 6)			Will the sale of alcohol be for consumption (Please tick box Y) (please read guidance note 7)	On the premises	<input checked="" type="checkbox"/>
				Off the premises	
Day	Start	Finish	Both		
Mon	17.00	00.30 23.00	State any seasonal variations for the supply of alcohol (please read guidance note 4) N/A		
Tue	17.00	00.30 23.00			
Wed	17.00	00.30 23.00			
Thur	17.00	00.30 23.00	Non-standard timings. Where you intend to use the premises for the supply of alcohol at different times to those listed in the column on the left, please list (please read guidance note 5) N/A		
Fri	17.00	00.30 23.00			
Sat	17.00	00.30 23.00			

Sun	17:00	23:00	

State the name and details of the individual whom you wish to specify on the licence as premises supervisor

Name OYA CUBUK
Address 56 GREEN LANES
NEWINGTON GREEN
Postcode N16
Personal Licence number(if known) LBH-PER-T-0686
Issuing licensing authority (if known) LONDON BOROUGH OF HACKNEY

N

Please highlight any adult entertainment or services, activities, other entertainment or matters ancillary to the use of the premises that may give rise to concern in respect of children (please read guidance note 8)

N/A

O

Hours premises are open to the public Standard timings (please read guidance note 6)			State any seasonal variation (please read guidance note 4)
Day	Start	Finish	
Mon	8:00	00:30 23:30	N/A
Tue	8:00	00:30 23:00	
Wed	8:00	00:30 23:30	
Thur	8:00	00:30 23:30	
Fri	8:00	00:30 23:30	
Sat	8:00	00:30 23:30	
Sun	8:00	23:00 23:00	

Non standard timings. Where you intend to use the premises to be open to the public at different times from those listed in the column on the left, please list (please read guidance note 5)

N/A

P

Describe the steps you intend to take to promote the four licensing objectives:

a) General – all four licensing objectives (b,c,d,e) (please read guidance note 9)

b) The prevention of crime and disorder

*WE WOULD ONLY BUY FROM RECOGNISABLE CASH AND CARRIES.
*CCTV IN OPERATION, WILL RECORD FOR 31 DAYS. FOOTAGE WILL BE AVAILABLE FOR POLICE + LOCAL COUNCIL OFFICERS.

c) Public safety

*NO OFF SALES OF ALCOHOL WOULD BE PERMITTED
*NO VERTICAL DRINKING PERMITTED.

d) The prevention of public nuisance

*SIGNAGE WILL BE POSTED ASKING CUSTOMER TO LEAVE QUIETLY.
*NO DRINKS ALLOWED ON THE OUTDOOR AREA

e) The protection of children from harm

*NO ENTRY TO UNDER 21 YR OLD.
*CHALLENGED 25 IN OPERATION
*STAFF WILL BE TRAINED IN CHALLENGE 25 + REFUSALS
ALCOHOL + REFUSAL BOOK TO BE KEPT + SIGNED MONTHLY BY MANAGER

Please tick ✓ yes

- I have made or enclosed payment of the fee ☐
- I have enclosed the plan of the premises ☐
- I have sent copies of this application and the plan to responsible authorities and others where applicable ☐
- I have enclosed the consent form completed by the individual I wish to be premises supervisor, if applicable ☐
- I understand that I must now advertise my application ☒
- I understand that if I do not comply with the above requirements my application will be rejected ☒

IT IS AN OFFENCE, LIABLE ON CONVICTION TO A FINE UP TO LEVEL 5 ON THE STANDARD SCALE, UNDER SECTION 158 OF THE LICENSING ACT 2003, TO MAKE A FALSE STATEMENT IN OR IN CONNECTION WITH THIS APPLICATION

Part 4 – Signatures (please read guidance note 10)

Signature of applicant or applicant's solicitor or other duly authorised agent. (See guidance note 11) If signing on behalf of the applicant please state in what capacity.

Signature 

Date 19-08-2014

Capacity

For joint applications signature of 2nd applicant or 2nd applicant's solicitor or other authorised agent. (please read guidance note 12) If signing on behalf of the applicant please state in what capacity.





Signature

Date

Capacity

Contact name (where not previously given) and postal address for correspondence associated with this application (please read guidance note 13)	
Post town	Post code
Telephone number (if any)	
If you would prefer us to correspond with you by e-mail your e-mail address (optional)	

CENGİZ PLACE PLAN 47 GREEN LANES

- Key
-  TABLE AND CHAIRS
 -  SMALL SIDE TABLES
 -  FIRE EXTINGUISHER
 -  DOORS
 -  FRIDGE

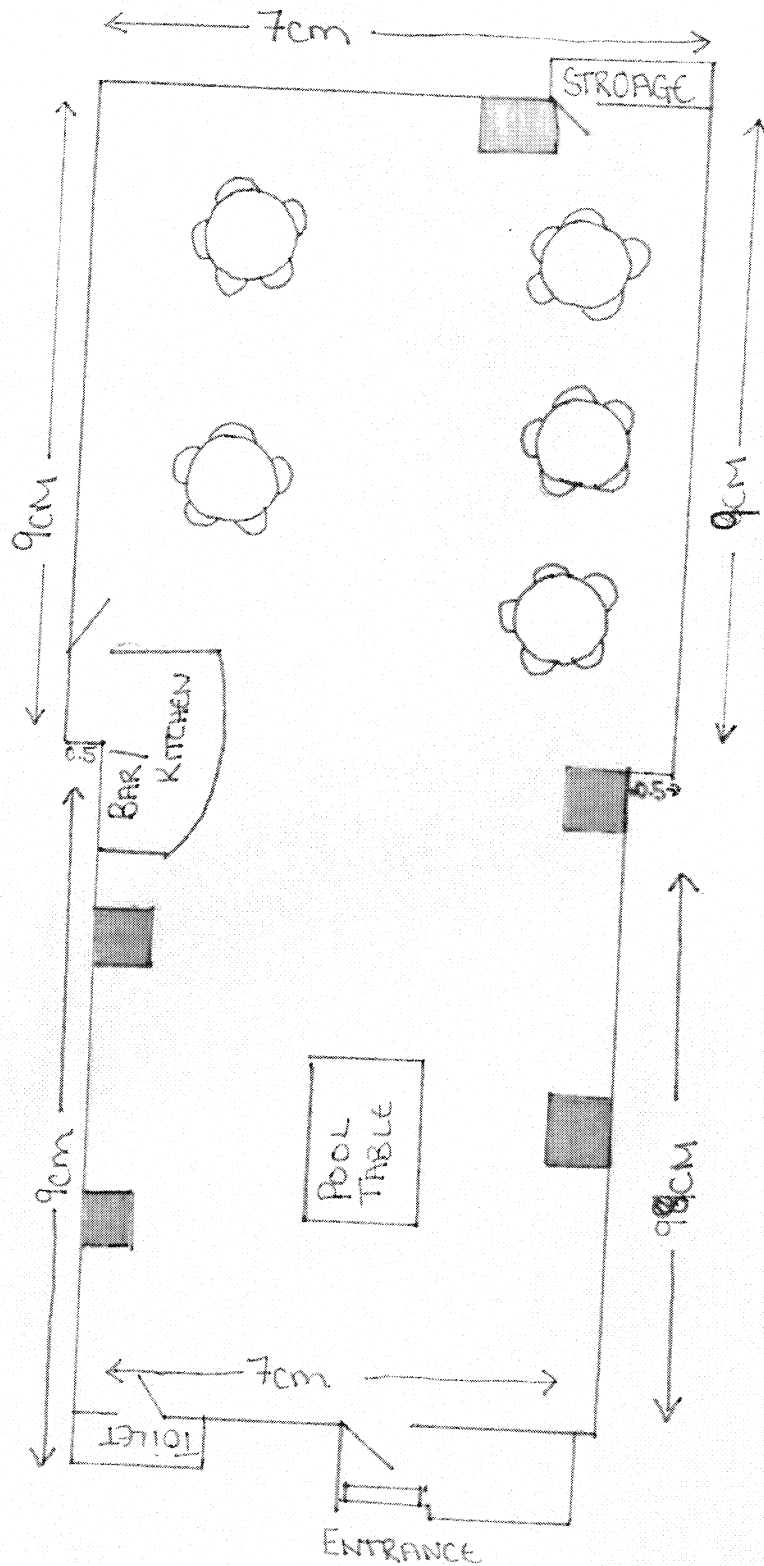

Dear Sir/Madam

I would like to apologies for making you feel concerned about your local area, I hope I would be able to reassure you, as we have put in place some procedure to minimize noise and unwanted behavior.

Firstly, I would like to state that music is not permitted in this venue as it not going to be ran as a bar nor club. This venue is designed for mainly over 40's to come in and communicate with others with something to drink there is also hot drinks availably to drink.

Secondly, as it is not ran as a traditional pub the people attending this venue would not be getting drank and causing problems in the area or to local pedestrians with inappropriate behavior.

I hope I was able to comfort you on your anticipation about noise not going to be an issue.

Yours Faithfully
Berivan Ulusoy

Dear Sir/Madam

I would like to apologize for making you feel concerned about your local area and fully understand you are making a better community for residents and children of our future. I hope I would be able to reassure you, as we have put in place some procedure to minimize noise, unwanted behavior and any illegal activities.

Firstly, I would like to state that there has been a new, strict and strong management put into place, where everyone is now informed of regulation and producers of selling alcohol if license is permitted, e.g. alcohol only sold to over 25's, it is not use of a bar nor night club and drinking while sitting is only allowed, reporting/writing any incidents of any unwanted behavior.

Secondly, as well as having a strong management we have also made agreements with the local police to install CCTV and provide any CCTV footage when needed which would stop any illegal activities to take place.

Furthermore, we would also be working together with Islington Noise Liaison officers and have agreed to the conditions they have said. In this venue loud would not be allow as loud music is a cause of unwanted behavior as people could get carried away drinking.

I hope I was able to comfort you on your anticipation, sorry for any inconveniences caused.

Yours Faithfully
Berivan Ulusoy

Baptiste, Anthony

Subject: FW: 49 Green Lanes N16 9BU

From:

Sent: 02 September 2014 15:51

To: Kay, Jenny

Subject: 49 Green Lanes N16 9BU

Der Jenny,

My name is xxxx, and I am the proprietor of xx Green Lanes N169BU.

I believe that giving licence to sell alcohol to no 47 Green Lanes N 169BU is not a good idea, because it will increase noise levels in the area and especially, on top of 47, (flats with little children) and on either side of 47 which are flats with family or students.

Many thanks,

Baptiste, Anthony

To: Baptiste, Anthony
Subject: FW: Cengis Place 47 Green Lanes: Alcohol licence application objection

From: xxxx
Sent: 02 September 2014 19:02
To: Williams, John
Subject: Cengis Place 47 Green Lanes: Alcohol licence application objection

Dear John,

I have been informed that the Turkish social club called Cengis Place at 47 Green Lanes has applied for a license to sell alcohol from 17:00 to 23:00 Monday to Sunday.

As a local resident who xxxx property if it is possible I would like to register my concern and objection toward this application. Over the last couple of years myself and other local residents have worked with the Council and Police to improve this section of Green Lanes to the benefit of the local residents and businesses, with the aim in developing a vibrant street serving the wider community. As a result we have also formed the Green Lanes xxxx to work together to achieve this objective. Together with the Council and Police we have seen some improvements on the street including the closure of illegal social clubs and are keen to ensure this continued success.

My concerns specifically with 47 Cengis Place are as follows:

- there are a great number of social clubs on this part of Green Lanes, some of which have been closed down due to illegal activity. This sheer volume of clubs is detrimental to the wider community as they are private and have proven to bring in issues of illegal gambling, crime, noise, anti social behaviour, increased traffic, and parking violations.
- there are already a number of licensed premises on the street including two public houses, numerous restaurants, as well as other social clubs. The addition of another licensed premises would not provide any additional benefit to the street and I believe would have a detrimental effect.
- I would be very concerned about the increase in noise and anti social behaviour with the introduction of alcohol. The road has a good mix of residential and business property and suffers from noise issues at present, so I don't believe an additional licensed premises will help in this matter. I also would anticipate the club being used for late night private functions as a result of an alcohol license, as has been observed on occasion in the 8 years I've lived on the road. This would bring in further unwelcome noise and anti social behaviour which can extend to beyond 11pm.
- specifically with regards to this premises the gentlemen who frequent it tend to sit outside in the lowered outside area. As well as being constantly observed as I come and go in xxxx I have noticed that many people, particularly women, would appear uncomfortable when passing this predominantly male club (except for one lady who works there). I don't believe the inclusion of alcohol will help in this regard.

I hope in reviewing this application you will take on board my concerns above, and I would also ask that my objection is kept confidential.

Regards,

Your

Our Licensing/NI

Date: 15/09/2014



**METROPOLITAN POLICE
SERVICE**

Licensing Team
Islington Police Licensing Unit
Islington Police Station
2 Tolpuddle Street
London
N1 0YY

Telephone: 07799133204

Facsimile:

Email:

licensingpolice@islington.gov.uk

Berivan ULUSOY
12B Kensworth House
Cranwood Street
London
EC1V 9PA

Dear Sir

Re: Premises Licence Application; Cengiz Place, 47 Green Lanes, Newington Green, N16 9BU

With reference to the above application, I am writing to inform you that the Metropolitan Police, as a Responsible Authority, will be objecting to this application as it is our belief that if granted the application would undermine the Licensing Objectives, being the Prevention of Crime and Disorder.

There are a number of licensed and unlicensed venues in the Newington Green area which police are aware are used for gambling. There are also intelligence reports linking various like venues to criminal gangs.

An email was sent to the applicant on the 28th of August 2014 requesting they accept our comprehensive wording to their CCTV condition. Since then a number of enquiries have taken place and it has been discovered that there are restricted criminal intelligence reports relating to the venue which give cause for concern over certain people linked with the venue.

We were hoping that the applicant would reply and that we could commence communication regarding the application and voice our concerns over these certain persons. To date there has been no communication back from the applicant whatsoever.

It is for these reasons that we are objecting to the application and propose that it is refused.

Should you wish to discuss the matter further please contact me on Mobile 07799133204 or via email, licensingpolice@islington.gov.uk

Yours sincerely

Peter Conisbee Pc 575NI

Paul Hoppe Pc 208NI
Steven Harrington Pc 425NI

Islington Police Licensing Team

Appendix 3

1. The premises shall install and maintain a comprehensive CCTV system as per the minimum requirement of a Metropolitan Police Crime Prevention Officer. The CCTV system shall continually record whilst the premises is open for licensable activities and during all times when customers remain on the premises. All recordings shall be stored for a minimum period as required by the Metropolitan Police Crime Prevention Officer. Recordings shall be made available immediately upon the request of the Police or authorised officer.
2. Only alcoholic drinks which are detailed on invoices will be purchased or accepted as part of a 'free' offer. Invoices (or copies) for all alcoholic goods on the premises will be made available to officers from the council, police or HMRC upon request.
3. No off sales permitted.
4. No vertical drinking permitted on the premises.
5. The licensee shall display a notice at the exit of the premises requesting customers leave the local area quietly.
6. No alcoholic drinks are permitted in the outside areas.
7. No entry for under 21 year olds.
8. The licensee shall adopt the Challenge 25 and the BII National Standards Proof of Age Scheme
9. The licensee shall ensure that staff are trained about the age limit for alcohol; the difficulty of accurately assessing age; acceptable 'proof of age' documents; and how to challenge for proof of age and how to refuse sales where necessary. The licensee shall further ensure that employees sign to confirm that they have understood the training. The licensee shall keep records of training and instruction given to staff.
10. The licensee and staff should note any refusals to sell to young people in a refusals log. The refusals log shall be checked and signed monthly by the designated premises supervisor. The refusals log shall be made available for inspection by the licensing team, police or trading standards.

Conditions suggested by the Noise Service (Agreed)

1. No refuse or waste collections to be carried out between 22:00 and 07:00 and anytime on Sunday or Bank Holidays.
2. Noise and vibration from the ventilation or extract systems shall not be allowed to emanate from the premises so as to cause a nuisance to nearby properties.
3. All ventilation and extract systems shall be designed and maintained so as to prevent noxious smells causing a nuisance to nearby properties.

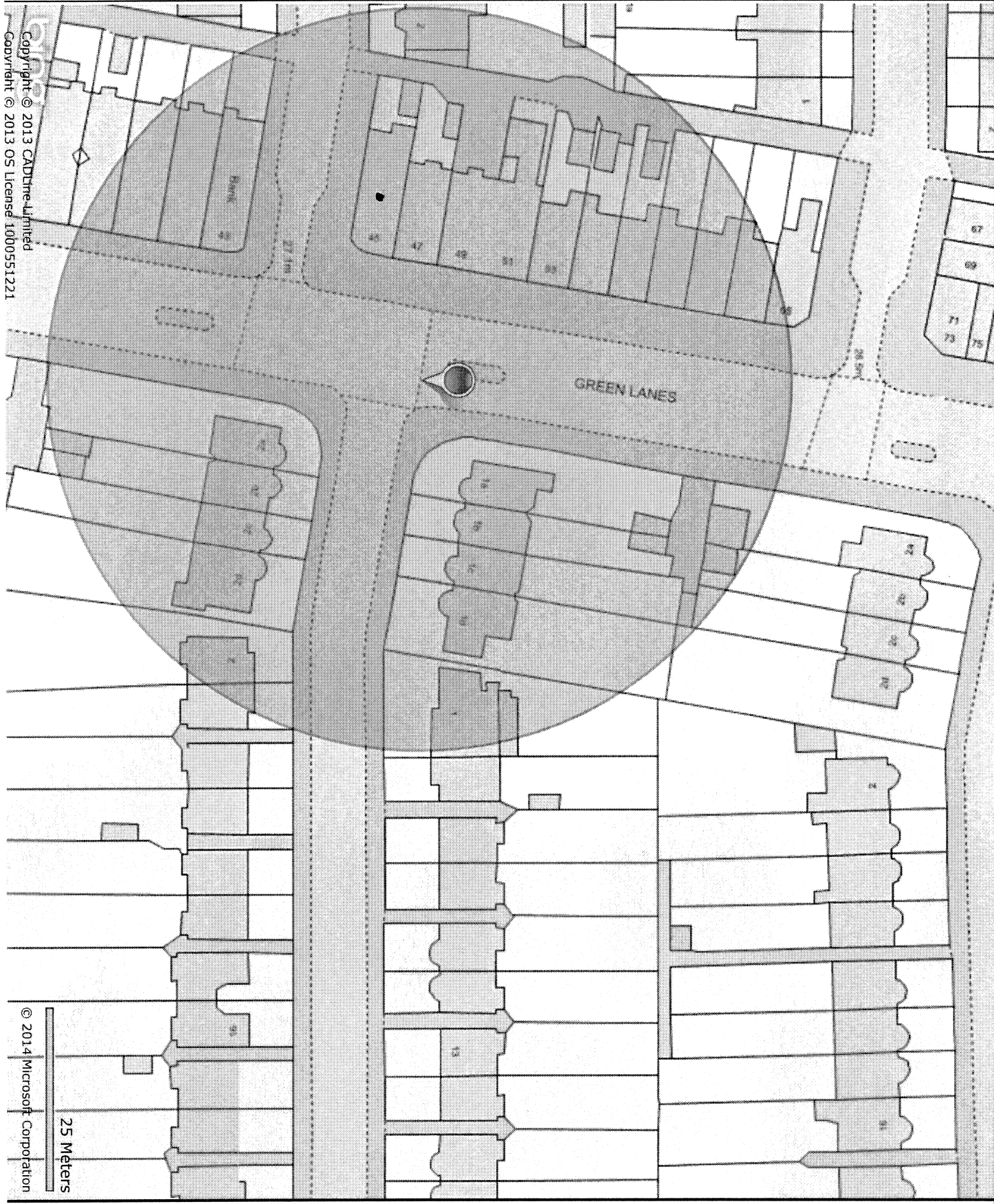

Title : 47 Green Lanes

Islington Borough
Boundary

Printed by :
RO RO

Printed at :
21-08-2014

Title : 47 Green Lanes

Islington Borough
Boundary